



PURE ALUMINUM DOG DOOR

With Heavy Duty Frame



Owner's Manual

CONGRATULATIONS!

Register Your New



eXtreme Dog Door
with Heavy Duty Frame

Activate Your 5-Year Warranty

You will need the following information ready to register:

1. Order #
2. Date of Purchase
3. Phone Number
4. E-mail address

To register, go to:

www.extremedogdoor.com/register
and follow the online directions.

Thank you for your purchase, and welcome to the family.

Getting Started

The following manual is a guide for installing your wall-mounted eXtreme Dog Door.

To see an instructional video for installing the door, please visit:

<https://www.youtube.com/watch?v=2ShtyDg-PY>

If you have any questions or concerns you can also visit us at:

<https://www.extremedogdoor.com/support/>

Or call our friendly and knowledgeable customer service team:

1-800-305-6116

These doors are simple to install by any handyman with common DIY power tools. Or, you can employ the services of a professional, should you feel the installation may be beyond your experience.

Important:

Please read the instructions in full before you proceed to install.

Should you decide to install the door by yourself, it is important that the appropriate safety gear is worn such as protective eyewear.

Types of Walls

There are certain tools you will use, and certain steps you will take no matter what type of wall you are cutting through.

Brief example of common wall types

- **Studded Wall**- Drywall interior, wood/ siding exterior. This is the easiest to cut.

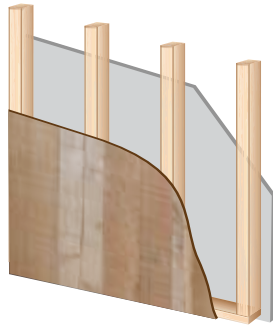

- **Block Wall/Stucco**- Drywall interior, cement blocks stacked to form outer walls with a layer of stucco on the out- side.

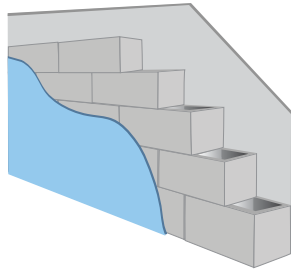

- **Brick Wall**- Drywall interior, brick exterior with a layer of plywood on the inside of the brick.

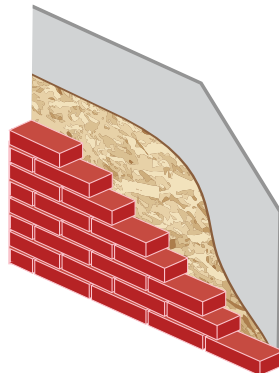



Part 1

Studded Wall

Tools Required

*Additional tools may be necessary depending on the wall type you are installing the door into.



Pencil

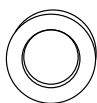

Masking tape



Measuring tape

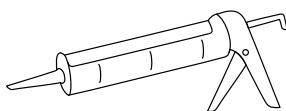

Construction silicone



Level

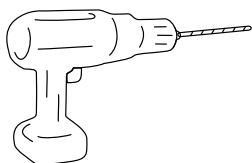

Drill

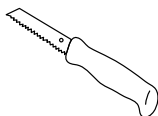

Jabsaw

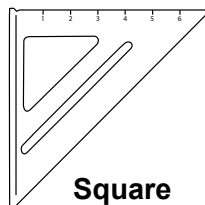

Square

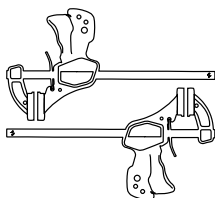

Trigger clamps



Eye Protection



Mask



Jigsaw

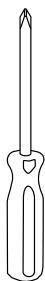

Screwdriver

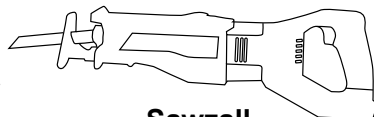

Sawzall

Step 1

Choose the installation position that best suits your pet(s) needs. (The top of the pet door opening should be 2" higher than the highest point on your tallest dog's back. The bottom of the pet door opening should be low enough for your smallest dog to walk over it comfortably, but must be at least 3" higher than the bottom of the door you are mounting it on.)

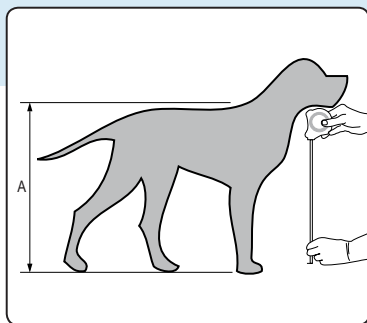

Step 2

Once you've found your desired location, you will want to locate any studs, wires or plumbing that may be contained within the wall. It is best to plan to be no closer than 8"

from either side of any door or window (though you can cut below a window without issue provided there are no electrical outlets, wiring or plumbing located there). Tape the included template to find a suitable location. You can also check along the exterior of your chosen spot to ensure there is no faucet or outdoor electrical fixtures.

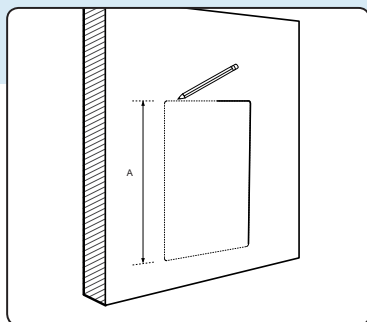

Important: Align the template to one of the existent studs (left or right).

Step 3

Using your drill and a long enough bit, drill 4 holes, one at the inside of each corner of your outline, all the way through to the outside.

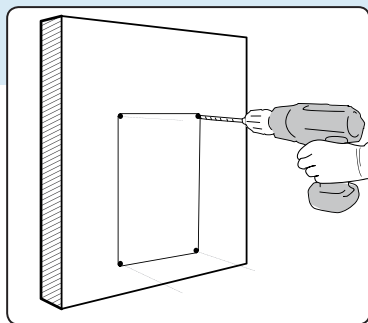

Step 4

Using a saw (preferably a jigsaw or sawzall, but a jabsaw can be used too) cut away the layer of drywall on the inside. Remove and dispose of any insulation that is packed into the wall. Place the inner door frame in the opening to make sure it fits properly and is level. If it is, take the door out and tape a sheet of plastic over the hole with tape to keep debris from getting into the house. If it is not quite the right size or level, remove the door and trim the hole a little more until it is correct.

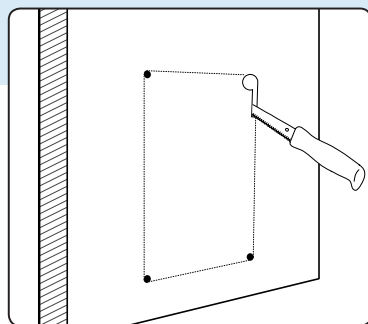

Step 5

On the outside wall, find the four pilot holes and trace an outline around them (on the outside) so that it matches your inside drawing. Double check again to be sure your cut lines are all level and plumb. We recommend putting blue tape around the outer edge to avoid damaging the wall with the saw boot.

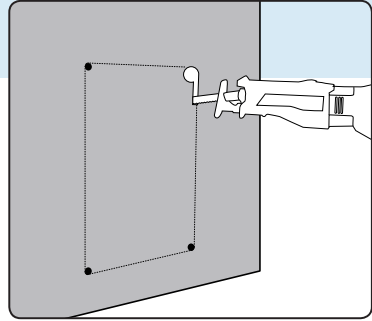

Step 6

When your outline has been drawn and taped, cut around the edge with your saw. When this is done and the debris removed, use your level to check that your lines are level and plumb.

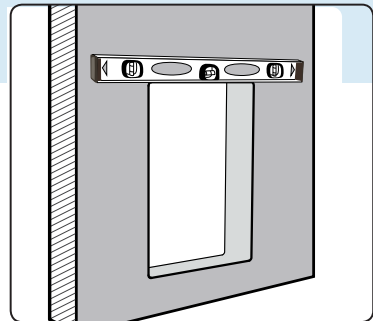

Step 7

Frame the opening to make the structural area stronger so in our case we will install 2 small pieces on the bottom (fillers), one long piece on the left as a spacer and another one on the bottom as the base.

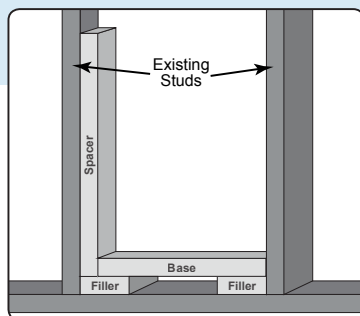

Step 8

Remove all the pieces that you don't need and clean the area so you can try the door to make sure it fits and there is no need for any more cutting.

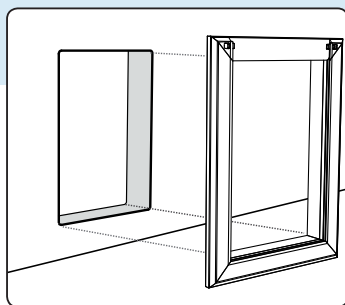

Please go to **Part 4** - Installing the door ►



Part 2

Block/Stucco Wall



Tools Required

*Additional tools may be necessary depending on the wall type you are installing the door into.



Pencil



Masking tape



Measuring tape

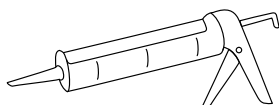

Construction silicone



Level

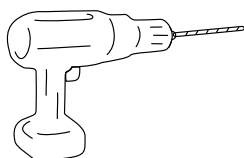

Drill



Screwdriver

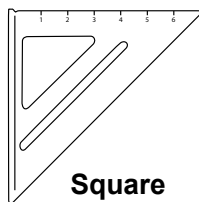

Square

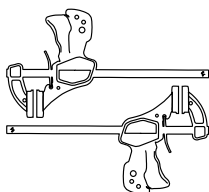

Trigger clamps



Mask



Eye Protection



Jigsaw

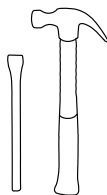

Hammer & Chisel

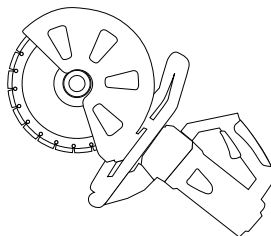

Masonry Saw

Step 1

Choose the installation position that best suits your pet(s) needs. (The top of the pet door opening should be 2" higher than the highest point on your tallest dog's back. The bottom of the pet door opening should be low enough for your smallest dog to walk over it comfortably, but must be at least 3" higher than the bottom of the door you are mounting it on.)

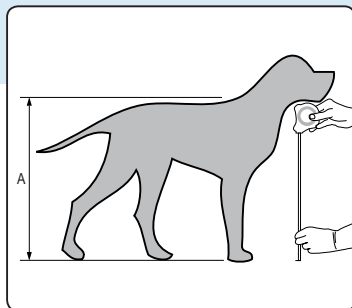

Step 2

Once you've found your desired location, you will want to locate any wires or plumbing that may be contained within the wall. Tape the included template to find a suitable location. You can also check along the exterior of your chosen spot to ensure there is no faucet or outdoor electrical fixtures.

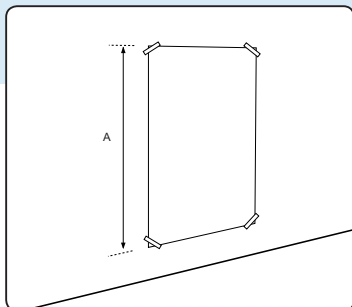

2a. Cut a square of drywall about 8" w x 4" h in the center of your template area. This is to locate a grout line in the block so as not to start cutting the bottom out of a block.

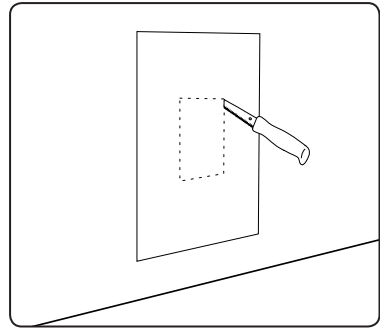

2b. Locate the next highest grout line above where the top of your template was. This is the new top of your template. Mark it and re-draw your outline to begin cutting.

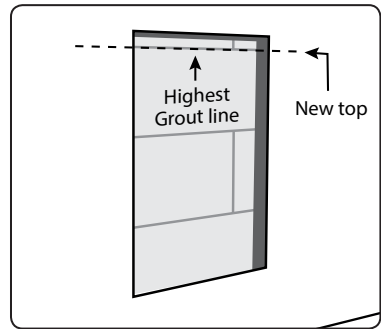

Step 3

Using your drill and a long enough bit, drill 4 holes, one at the inside of each corner of your outline, all the way through to the outside.

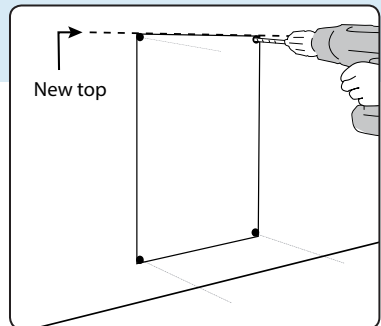

Step 4

Using a saw (preferably a jigsaw or sawzall, but a jabsaw can be used too) cut away the layer of drywall on the inside. Place the inner door frame in the opening to make sure it fits properly and is level. If it is, take the door out and tape a sheet of plastic over the hole with tape to keep debris from getting into the house. If it is not quite the right size or level, remove the door and trim the hole a little more until it is correct.

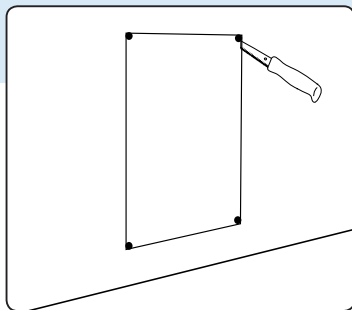

Step 5

Go outside to where the drill marks are and draw your outline around them making sure everything is leveled.

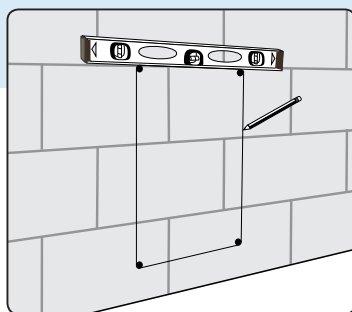

Important: Before the next step please make sure to wear appropriate protection for your eyes, hands and arms.

Step 6

Using your masonry saw, cut along your cutlines in the stucco. This will prevent spider cracking when you return to pound out the blocks.

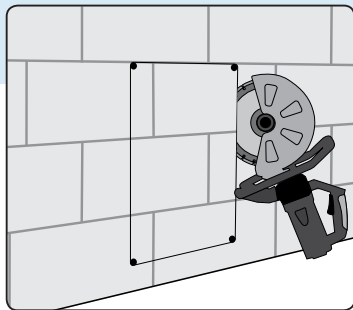

Step 7

Back at the inside wall, use your hammer to first smash through the middle of the blocks you will be removing. This will relieve the load and make them easier to pound out.

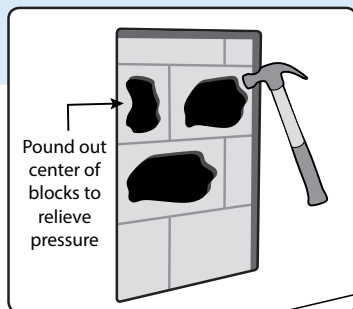

Step 8

Chisel around the opening and all along the grout line until you reach the part of the block at the bottom that you will keep (flush with the bottom of the opening). Chisel across at the opening to create a seam.

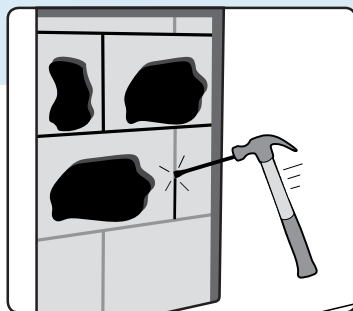

Step 9

Optional: To make things easier use a rotary hammer and drill holes along the seam you've created and all around the opening.

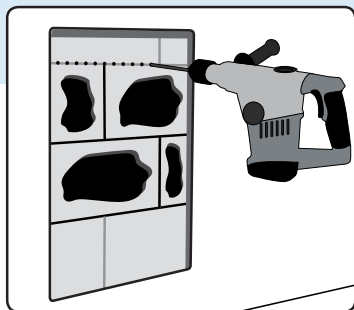

Step 10

Go around to the outside where you sawed through the stucco and pound through the stucco and block to the inside, all along your cut lines, pulling out the rest of the block pieces and debris. Remember to use tape to cover the inside opening with a sheet of plastic to prevent debris from blowing into the house.

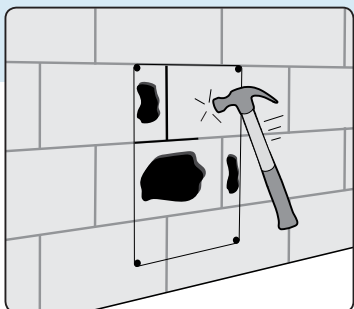

Please go to **Part 4** - Installing the door ►



Part 3

Brick Wall



Tools Required

*Additional tools may be necessary depending on the wall type you are installing the door into.



Pencil

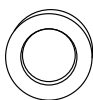

Masking tape



Measuring tape

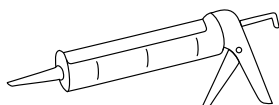

Construction silicone

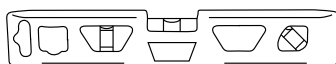

Level

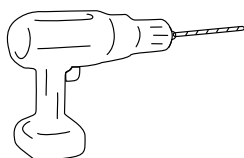

Drill



Screwdriver

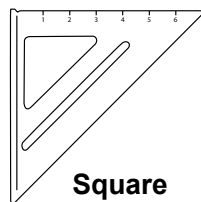

Square

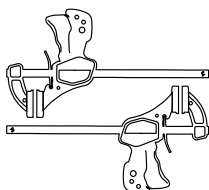

Trigger clamps



Mask



Eye Protection



Jigsaw

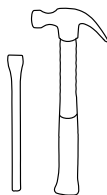

Hammer & Chisel

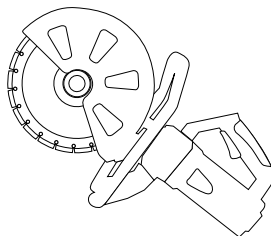

Masonry Saw

Step 1

Choose the installation position that best suits your pet(s) needs. (The top of the pet door opening should be 2" higher than the highest point on your tallest dog's back. The bottom of the pet door opening should be low enough for your smallest dog to walk over it comfortably, but must be at least 3" higher than the bottom of the door you are mounting it on.)

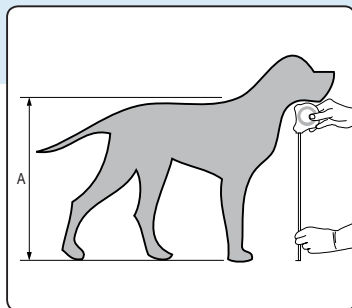

Step 2

Once you've found your desired location, you will want to locate any wires or plumbing that may be contained within the wall. Tape the included template to find a suitable location. You can also check along the exterior of your chosen spot to ensure there is no faucet or outdoor electrical fixtures.

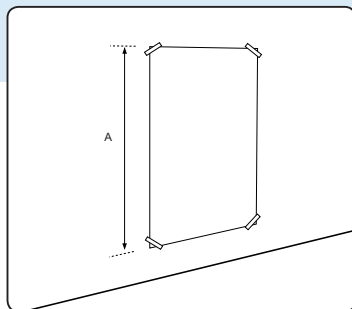

Step 3

Because we must locate a grout line on the outside, we will be using an approximate height location on the inside to begin with. Use the template to outline the location. Find the center point of the template and mark it.

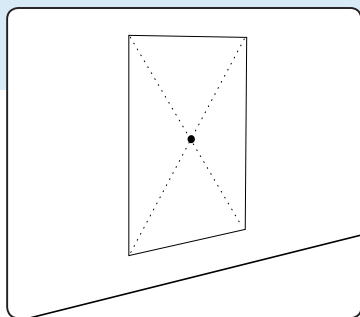

Step 4

Drill a hole through the drywall, plywood and brick at this point, all the way to the outside. Make sure the drill is leveled and straight while you are drilling.

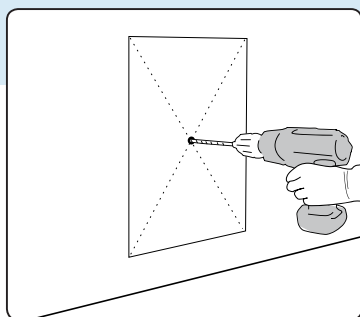

Step 5

On the outside wall, find the pilot hole you drilled. Find the grout line closest to the top of your approximate location and mark the center. Re-draw your outline on the brick, making sure your line is level and plumb.

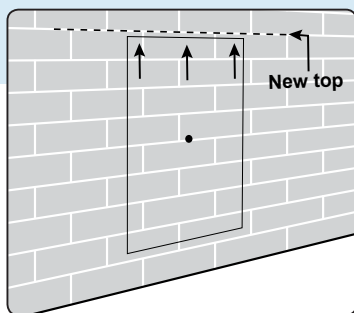

Step 6

Using your drill and a long enough bit, drill the top two holes, one at the inside of each corner of your outline, all the way through to the inside. Make sure the drill is leveled and straight while you drilling.

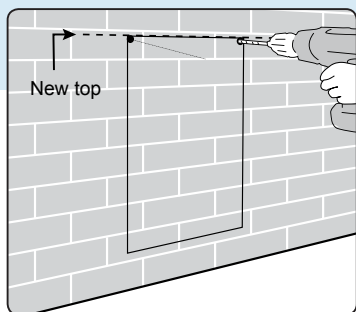

Step 7

Go back to the inside wall and, using the top pilot holes and your template, re-draw your outline. Find the bottom corners and drill the bottom, pilot holes through the plywood.

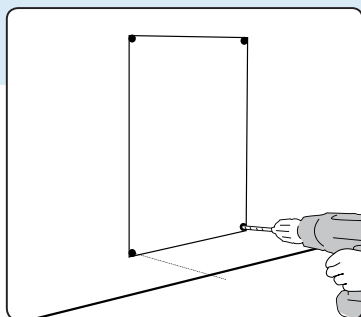

Step 8

Using a saw (preferably a jigsaw or sawzall, but a jabsaw can be used too) cut away the layer of drywall on the inside. Place the inner door frame in the opening to make sure it fits properly and is level. If it is, take the door out and tape a sheet of plastic over the hole with tape to keep debris from getting into the house. If it is not quite the right size or level, remove the door and trim the hole a little more until it is correct.

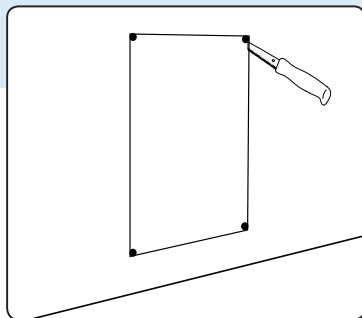

Step 9

Head back to the outside wall where you've marked your new opening. Using the masonry saw with a 14" diamond tipped blade, cut through the brick and plywood along the outline. With the chisels and small mallet, chip away any remaining brick fragments, till the opening is clear.

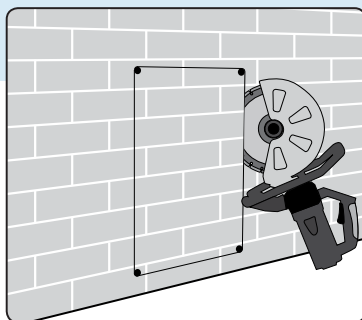

Important: Please make sure to wear appropriate protection for your eyes, hands and mouth.

Please go to **Part 4** - Installing the door ►



Part 4

Installing the Door



Step 1

Once you have cut your opening, measure from the inside opening edge to the outside opening edge. Add 1/4 inch from this number. This is what you are going to cut the aluminum pieces down to.

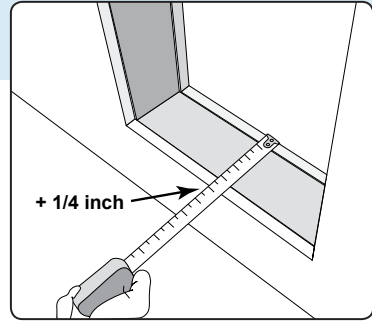

Step 2

Taking that number, measure the aluminum panels from front to back and mark the length of your tunnel. These will be your cut lines.

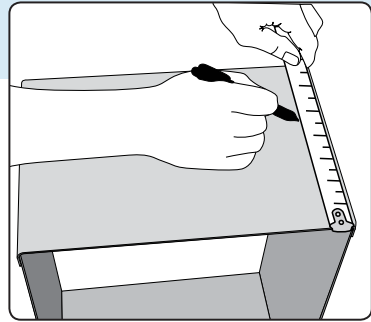

Step 3

Use a jigsaw, sawzall or a circular saw to cut the tunnel pieces. We recommend to use blades for metal and to wear appropriate protection for you eyes, hands and arms.

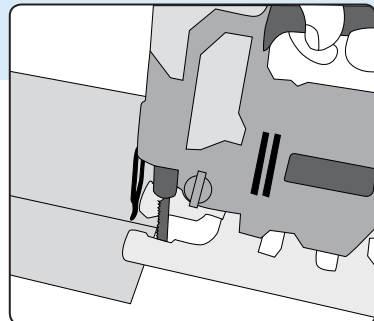

Step 4

Once the pieces are cut to size, you can assemble the tunnel. Using the included hardware, screw the top panels to the side panels.

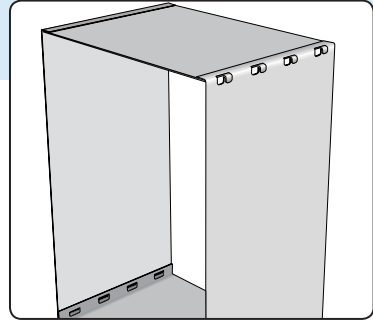

Step 5

Fit the assembled tunnel inside of the exterior door leaving the smooth, uncut edges out. Drill the pieces together in all 4 corners, you can use the trigger clamps to hold them in place

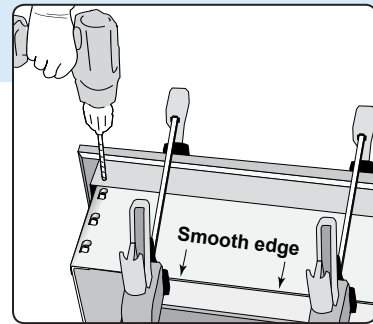

Step 6

Install the screws in each hole from the inside. If the screws are hard to install try to re-drill them with a slightly bigger drill bit.

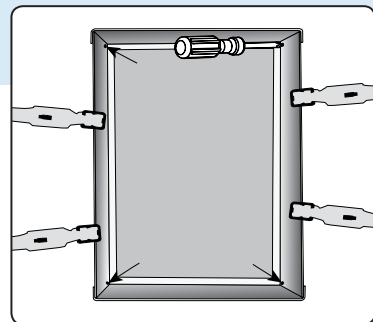

Step 7

Mark 1 inch and 1/4 from the smooth edge so you can pre-drill the holes (all 4 corners), without going too wide, you will be using to secure the internal half of the door later.

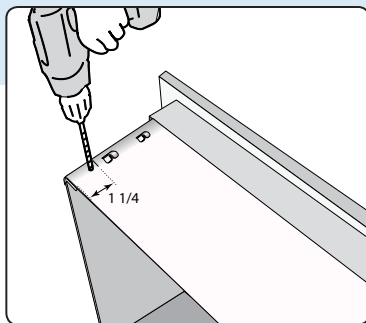

Step 8

Apply a generous bead of silicone around the cutout on both sides of the door that you're mounting your dog door in. This creates a weather seal.

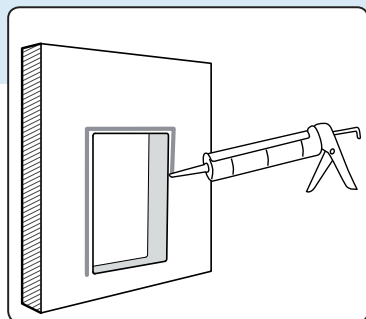

Step 9

Insert the external half with the installed tunnel from the outside of the house. Then insert the internal half of the door and make sure everything fits, make adjustments if it doesn't.

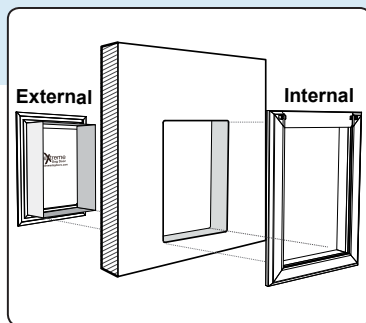

Step 10

Using the trigger clamps hold both pieces securely so you can install the last screws. Check that the whole door is leveled and make any adjustment if necessary.

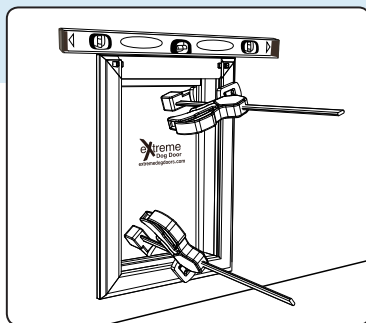

Important: Please make sure not to put too much pressure with the clamps so you don't bend or brake the door sides.

Step 11

Use the holes that you pre-drilled before as a guide to drill the internal half of the door and install the screws on all 4 corners.

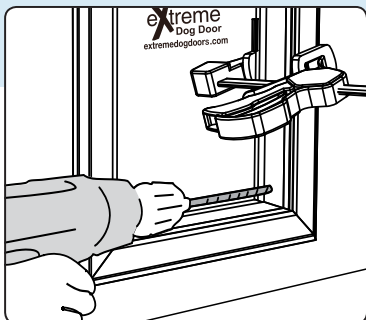

Tip: You can tape the flap to the wall temporarily so it is not in your way while you install the screws

Step 12

Drill at least 2 holes in both sides of the door to secure the door to the existent stud and also the spacer you installed.

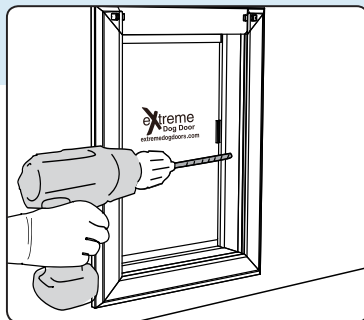

Tip: Remove all the pieces that you don't need and clean the area before the next step.

Step 13

Caulk the inside bottom and sides of the door where the tunnel meets the interior and exterior halves of the door. We recommend Clear caulk for this part.

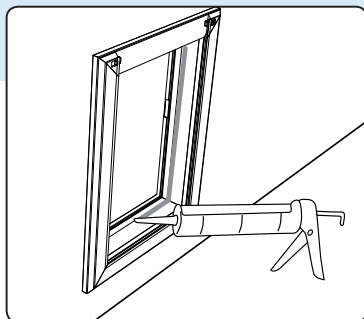

Tip: Remember to take off all the blue plastic which protects the door from getting scratches.

Step 14

Apply a silicone bead around the outer frame of the dog door, inside and outside of the house, to provide a neat finish. Apply another bead inside the frame, where the overlapping ends, to complete the installation with a neat finish.

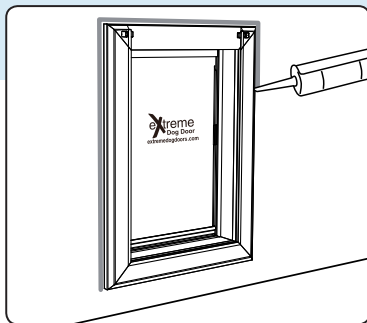

Tip: Allow the silicone beads to dry for 2 hours before removing the clamps. The silicone should completely set for approximately 24 hours.

Step 15

Attach the lift knob to the security panel by feeding the nipple anchor through the panel's hole. On the other side of the panel, place the washer over the threading and twist the knob over it in a clockwise direction until secure.

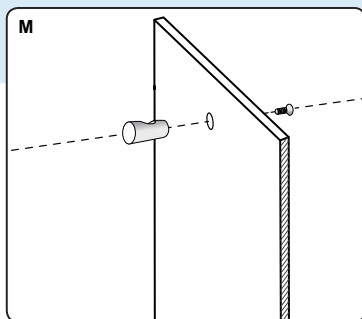

Notes



Contact us at 1-800-531-3527
www.extremedogdoor.com