



ALUMINUM DOG DOOR



Owner's Manual

CONGRATULATIONS!

Register Your New



eXtreme Dog Door
Activate Your 5-Year Warranty

You will need the following information ready to register:

1. Order #
2. Date of Purchase
3. Phone Number
4. E-mail address

To register, go to:

www.extremedogdoor.com/register

and follow the online directions.

Thank you for your purchase, and welcome to the family.

Installation Steps

These doors are simple to install by any handyman with common DIY power tools. Or, you can employ the services of a professional, should you feel the installation may be beyond your experience.

Important:

Please read the instructions in full before you proceed to install.

Should you decide to install the door by yourself, it is important that the appropriate safety gear is worn such as protective eyewear.

What's inside the box

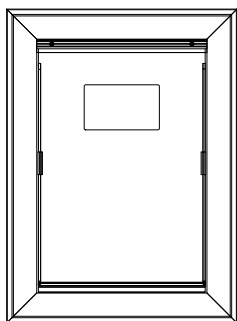

x1

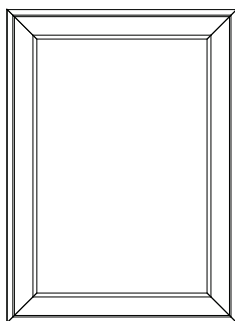

x1



x1

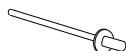

x8
(3x20mm)



x6
(4x40mm)

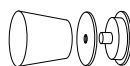

x1

Tools Required



Pencil

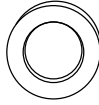

Masking tape



Measuring tape

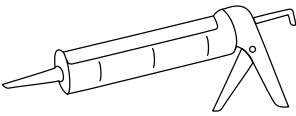

Construction silicone

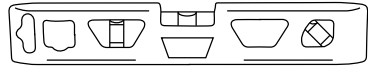

Level

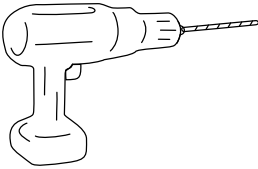

Drill

3/8" (10mm) drill bit minimum

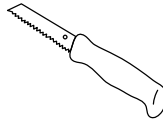

Jabsaw

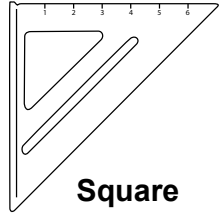

Square

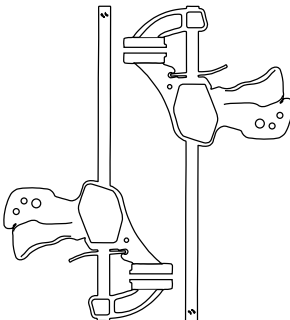

Trigger clamps

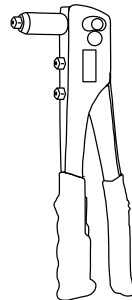

Rivet gun

Step 1

Choose the installation position that best suits your pet(s) needs. (The top of the pet door opening should be 1" higher than the highest point on your tallest dog's back. The bottom of the pet door opening should be low enough for your smallest dog to walk over it comfortably, but must be at least 3" higher than the bottom of the door you are mounting it on.)

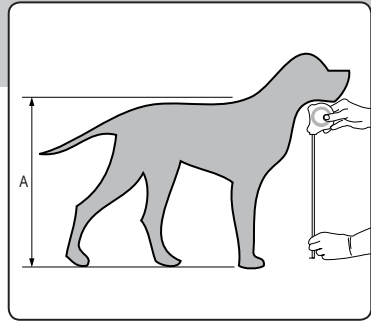

Step 2

Use masking tape to mark the bottom of the cutout measurements for the size door you purchased (be sure to add 1/4" to height and to width for sufficient installation clearance). Use a pencil to draw out the full rectangular cutout, as a guide for a straight, clean cut.

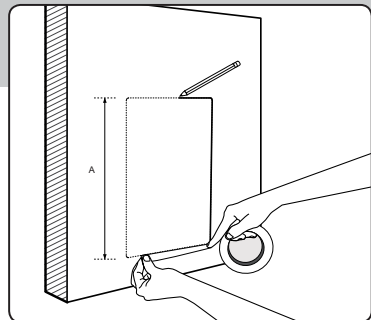

Step 3

Step 3. Drill a hole inside each of the four corners of your rectangle cutout template, using a 3/8" (10 mm) drill bit.

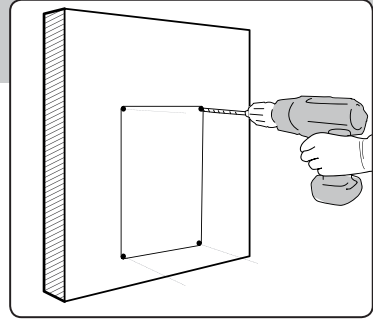

Step 4

Using a saw (preferably a jigsaw or reciprocating saw, but a jabsaw can be used too), cut out the mounting hole using your drilled holes as starting points and your pencil outline as a guide.

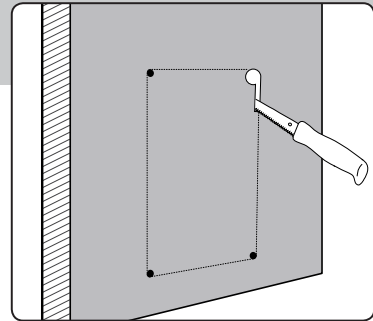

Step 5

Apply a generous bead of construction grade silicone all the way around the perimeter of the internal half of the dog door's sleeve area.

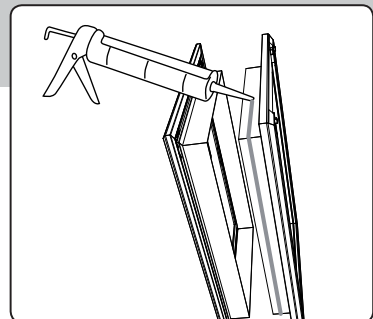

Step 6

Apply a generous bead of silicone around the cutout on both sides of the door that you're mounting your dog door in. This creates a weather seal.

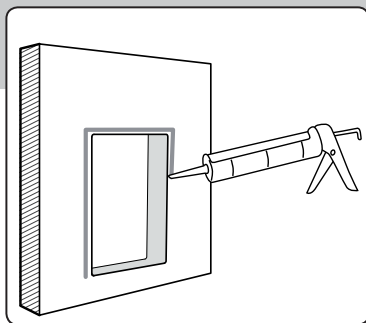

Step 7

Insert the internal and external halves of your dog door frame into the cutout and clamp them together tightly using trigger clamps.

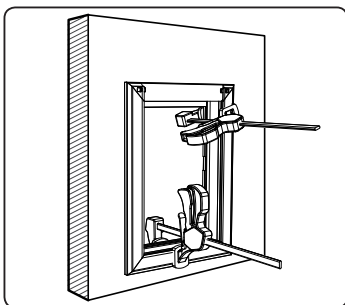
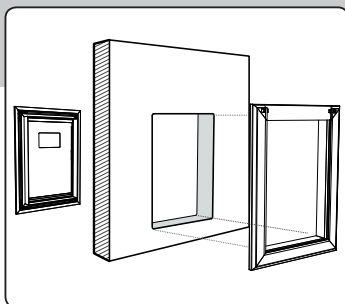

Step 8

Ensure that your dog door frame is level, and drill 1/8" (3mm) pilot holes for your screws or rivets. These securing points should be distributed around the sides, top and bottom of the overlapping sleeve joints of the internal and external dog door frames.

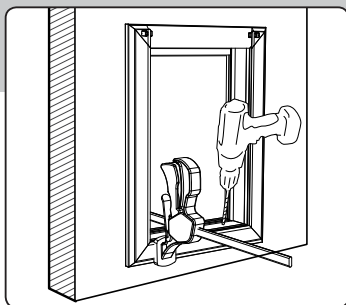

For solid wood doors, you can use the included screws. For hollow or foam filled doors, you can use the included rivets.

Step 9

Secure your dog door in place using the screws or rivets.

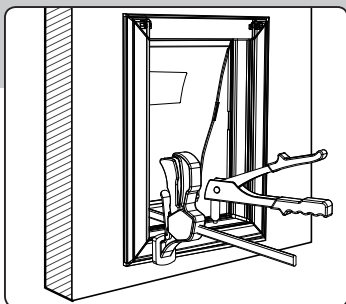

Step 10

Apply a silicone bead around the outer frame of the dog door, inside and outside, to provide a neat finish. Apply another bead inside the frame, where the overlapping ends, to complete the installation with a neat finish.

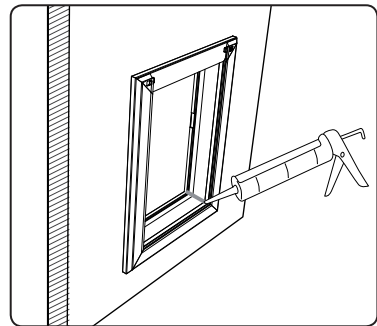
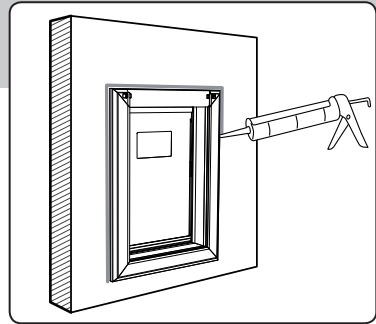

Allow the silicone beads to dry for 2 hours before removing the clamps. The silicone should completely set in approximately 24 hours.

Step 11

Attach the lift knob to the security panel by feeding the nipple anchor through the panel's hole. On the other side of the panel, place the washer over the threading and twist the knob over it in a clockwise direction until secure.

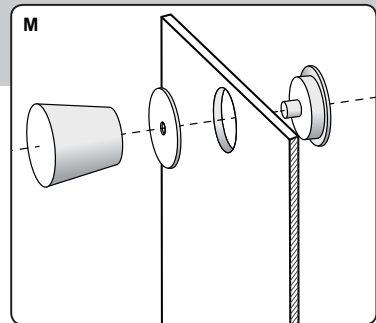



Contact us at 1-800-305-6116
www.extremedogdoor.com